



NextDay Inspect
46179 Westlake Dr, Suite 200 B
Sterling, VA 20165

www.NextDayInspect
(703) 450-6398

Property Address:

21 Sample St, Sample VA, 10000

Inspection Date: 01/04/2020

Termite Inspector Findings

Findings: I found evidence of termites
Recommendations: Subterranean Termite Treatment



Customer Invoice & Workorder

NEXT DAY INSPECT
46179 WESTLAKE DR SUITE 200
STERLING VA, 20165

Date of Service:	01/04/2020
Service:	WDI Inspection
License Number:	8999
Invoice Number:	3614142
Property Number:	434986
Address Serviced:	CURRENT RESIDENT 78 MOFFETT AVE WARRENTON VA, 20186
Phone:	703-450-6398 (day) 202-204-6098 (fax)
Email:	INFO@NEXTDAYINSPECT.COM
Agent:	NEXT DAY INSPECT

Inspection Details

Structure: HOUSE

Visibility: Visible dead insects: TERMITE SHELTER TUBING ON FLOOR JOISTS AND SUBFLOORING IN BASEMENT UNFINISHED AREA; Visible damage: TERMITE DAMAGE TO SUBFLOORING IN BASEMENT UNFINISHED AREA

Treatment: Previous treatment:

Recommendations: Recommend treatment: SUBTERRANEAN TERMITES

Obstructions: Basement: 1.3.4.5.6.7.8.9.11.13.14.24 ; Main level: 1.3.4.6.7.8.9.11.13.14.24. ; Attic: 11.13.24 ; Exterior: 11.13.16 ;

Notes

I FOUND EVIDENCE OF TERMITES

Technician(s)

BILLY COLES - 137767-T

Customer Signature

No Signature



Property Graph

Address: Current Resident 78 MOFFETT AVE WARRENTON VA, 20186

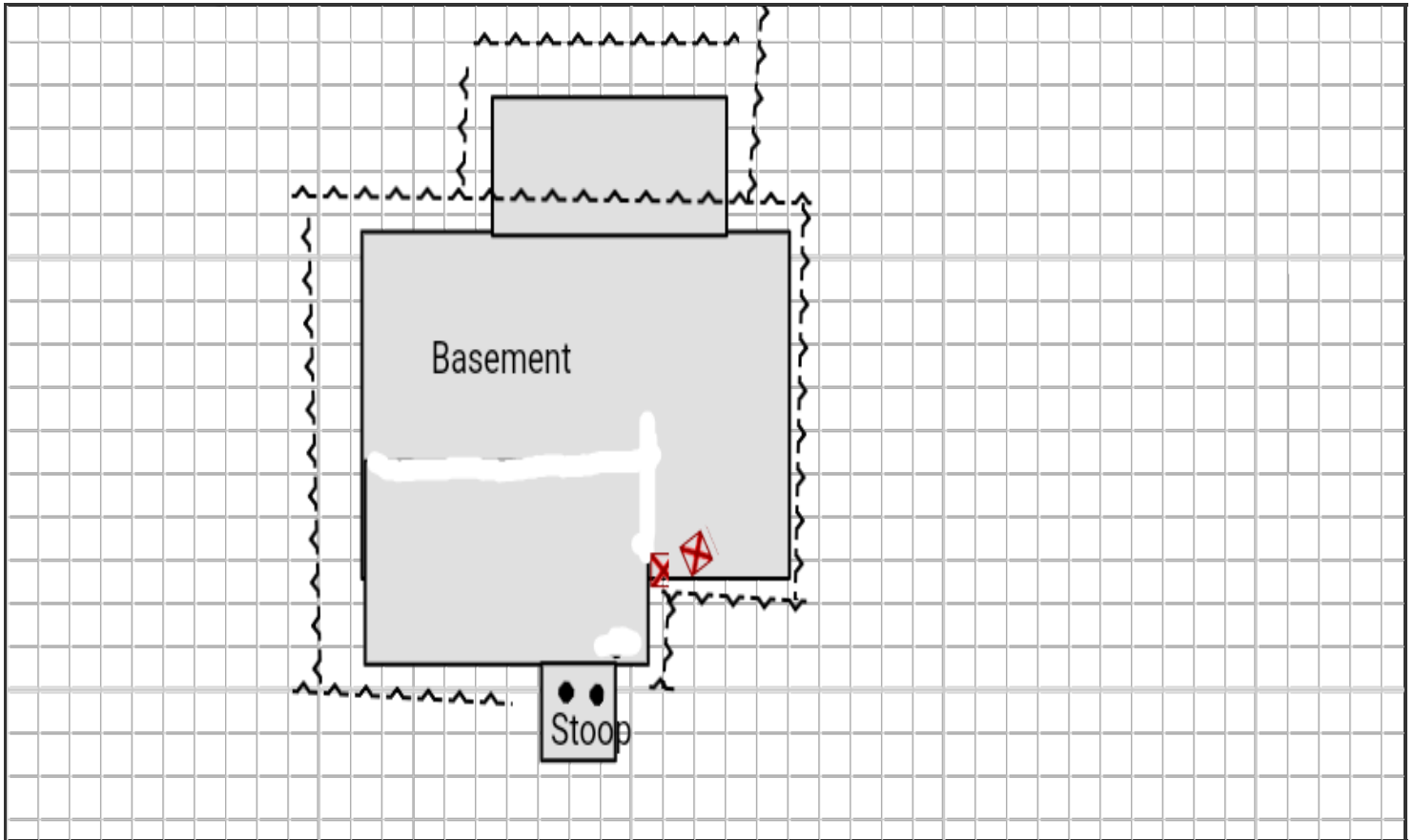

Section II. Inspection Findings This report is indicative of the condition of the above identified structure(s) on the date of the inspection is not to be construed as a guarantee or warranty against latent, concealed, or future infestation or wood destroying insect damage. **Based on a careful visual inspection of the readily accessible areas of the structure(s) inspected:**

- A. **No Visible** evidence of wood destroying insects was observed.
- B. **Visible** evidence of wood destroying insects was observed as follows:
- Live insects (description and location):
- Dead insects, insect parts, frass, shelter tubes, exit holes, or staining (description and location): TERMITE SHELTER TUBING ON FLOOR JOISTS AND SUBFLOORING IN BASEMENT UNFINISHED AREA
- Visible damage from wood destroying insects was noted as follows (description and location): TERMITE DAMAGE TO SUBFLOORING IN BASEMENT UNFINISHED AREA

NOTE: This is not a structural damage report. If box B above is checked, it should be understood that some degree of damage, including hidden damage, may be present. If any questions arise regarding damage indicated by this report, it is recommended that the buyer or any interested parties contact a qualified structural professional to determine the extent of damage and the need for repairs.

The inspecting company can give no assurances with regard to work done by other companies. The company that performed the treatment should be contacted for information on treatment and any warranty or service agreement which may be in place.

Section III. Recommendations/Treatment

- No action and/or treatment recommended: (Explain if Box B in Section II is checked)
- Recommend action(s) and/or treatment(s) for the control of: SUBTERRANEAN TERMITES

NO TREATMENT PERFORMED AT THIS TIME

Section IV. Obstructions and Inaccessible Areas

The following areas of the structure(s) inspected were obstructed or inaccessible:

- Basement 1.3.4.5.6.7.8.9.11.13.14.24
- Crawlspace _____
- Main Level 1.3.4.6.7.8.9.11.13.14.24.
- Attic 11.13.24
- Garage _____
- Exterior 11.13.16
- Porch _____
- Addition _____
- Other _____

The inspector may write out obstructions or use the following key:

- | | |
|-------------------------|--|
| 1. Fixed ceiling | 15. Standing water |
| 2. Suspended ceiling | 16. Dense vegetation |
| 3. fixed wall covering | 17. Exterior Siding |
| 4. Floor covering | 18. Window well covers |
| 5. Insulation | 19. Wood pile |
| 6. Cabinets or shelving | 20. Snow |
| 7. Stored items | 21. Unsafe conditions |
| 8. Furnishings | 22. Rigid foam board |
| 9. Appliances | 23. Synthetic stucco |
| 10. No access or entry | 24. Duct work, wiring, and/or plumbing |
| 11. Limited access | 25. Spray foam insulation |
| 12. No access beneath | 26. Equipment |
| 13. Only visual access | |
| 14. Cluttered condition | |

Section V. Additional Comments and Attachments (these are an integral part of the report)

Important: This form is invalid unless signed by seller and purchaser and unless payment is made or funds escrowed.

Signature of Seller(s) or Owner(s) if refinancing. Seller discloses to the buyer all information, to their knowledge, regarding W.D.I. infestation, damage, repair, and treatment history.

X

Print name of Property Owner/Seller.

Signature of Buyer. The undersigned hereby acknowledges receipt of a copy of the report and understands the information reported.

X

Important Consumer Information Regarding the Scope and Limitations of the Inspection.

Please read this entire page as it is part of this report. Please refer to the NPMA Suggested Guidelines for Instructions on completing this report. This report is not a guarantee or warranty as to the absence of wood destroying insects nor is it a structural integrity report. The inspector's training and experience do not qualify the inspector in damage evaluation or any other building construction technology and/or repair.

- About the Inspection:** A visual inspection was conducted in the readily accessible areas of the structure(s) indicated (see Page 1) including attics and crawlspaces which permitted entry during the inspection. The inspection included probing and/or sounding of unobstructed and accessible areas to determine the presence or absence of visual evidence of wood destroying insects. The WDI Inspection firm is not responsible to repair any damage or treat any infestation at the structure(s) inspected, except as may be provided by separate contract. Also, wood destroying insect infestation and/or damage may exist in concealed or inaccessible areas. The inspection firm cannot guarantee that any wood destroying insect infestation and/or damage disclosed by this inspection represents all of the wood destroying insect infestation and/or damage which may exist as of the date of the inspection. **For purposes of this inspection, wood destroying insects include: termites, carpenter ants, carpenter bees, and reinfesting wood boring beetles. This inspection does not include mold, mildew or non-insect wood destroying organisms.** This report shall be considered invalid for purposes of securing a mortgage and/or settlement of property transfer if not used within ninety (90) days from the date of inspection. **This shall not be construed as a 90-day warranty.** There is no warranty, express or implied, related to this report unless a written warranty or service agreement is attached.
- Treatment Recommendation Guidelines Regarding Subterranean Termites:** Treatment or corrective action should be recommended if live termites are found. If no evidence of a previous treatment is documented and evidence of infestation is found, even if no live termites are observed, treatment or corrective action by a licensed pest control company should be recommended. Treatment of corrective action may be recommended if evidence of infestation is observed, and a documented treatment occurred previously, unless the structure is under warranty or covered by a service agreement with a licensed pest control company.
For other Wood Destroying Insects, please refer to the NPMA suggested guidelines for added guidance on actions and or treatment.
- Obstructions and Inaccessible Areas:** No inspection was made in areas which required the breaking apart or into, dismantling, removal of any object, including but not limited to: moldings, floor coverings, wall coverings, siding, fixed ceilings, insulation, furniture, appliances, and/or personal possessions; nor were areas inspected which were obstructed or inaccessible for physical access on the date of inspection. Your inspector may write out inaccessible areas or use the key in Section IV. Crawl spaces, attics, and/or other areas may be deemed inaccessible if the opening to the area is not large enough to provide physical access for the inspector or if a ladder was required for access. Crawl spaces (or portions thereof) may also be deemed inaccessible if there is inadequate clearance from the bottom of the floor joists to the surface below. If inaccessible, reasons will be noted in Section IV of this report. If any area which has been reported as inaccessible is made accessible, the inspection company may be contacted for another inspection. An additional fee may apply.
- Consumer Maintenance Advisory Regarding Integrated Pest Management for Prevention of Wood Destroying Insects. Any structure can be attacked by wood destroying insects.** Homeowners should be aware of and try to eliminate conditions which promote insect infestation in and around their structure(s). Factors which may lead to wood destroying insect infestation include: earth to wood contact, foam insulation at foundation in contact with soil, faulty grade, improper drainage, firewood against structure(s), insufficient ventilation, moisture, wood debris in crawl space, wood mulch or ground cover in contact with the structure, tree branches touching structure(s), landscape timbers and wood decay. Should these or other conditions exist, corrective measures should be taken in order to reduce the chances of infestation of wood destroying insects and the need for treatment.
- Neither the inspecting company nor the inspector has had, presently has, or contemplates having any interest in the property inspected.**